

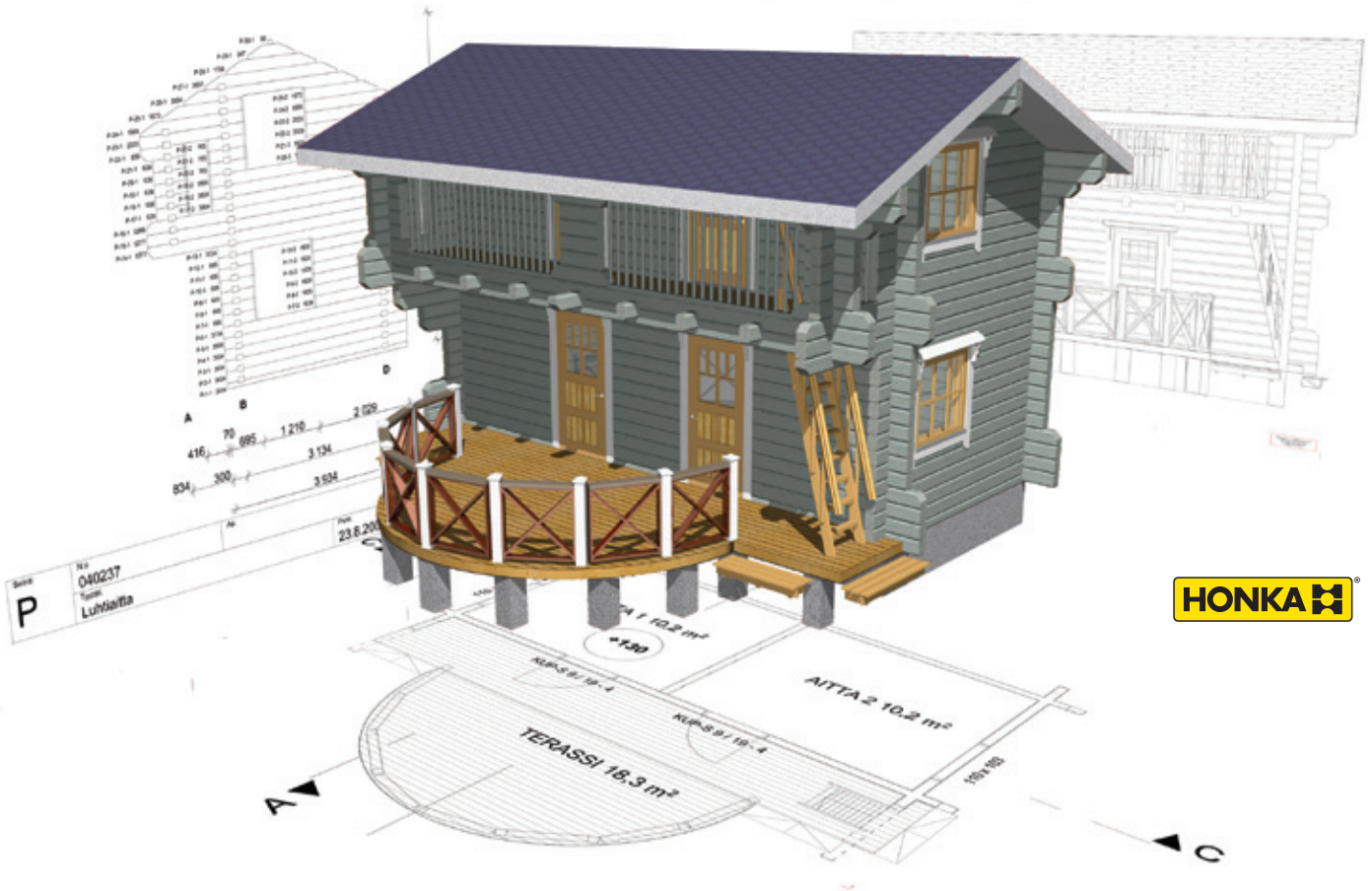

Log home design made easy – one program does it all



ArchiLogs is a leading-edge, comprehensive software solution for designing, marketing, and manufacturing log homes. It is an add-on to ArchiCAD, the industry leader in computer-aided architectural design. ArchiLogs helps ArchiCAD produce a 3D virtual model of the log home, which is used to generate plans, sections, elevations, construction details, object schedules, bills of quantities, renderings, animations, virtual reality scenes, and even CNC code.

000051	1600	01	26196	0	0	1700	935
000052	Seinö 024-13-1			0	0	0	0
000052	0100	03	0	0	0	900	900
000052	0100	-3	28596	0	0	900	900
000052	1600	01	2480	0	0	1700	935
000052	1600	01	26196	0	0	1700	935
000053	Seinö 024-14-1			0	0	0	0
000053	0100	03	0	0	0	900	900
000053	0100	-3	28596	0	0	900	900
000053	1600	01	2480	0	0	1700	935
000053	1600	01	26196	0	0	1700	935
000054	Seinö 024-15-1			0	0	0	0
000054	0100	03	0	0	0	900	900
000054	0100	-3	28596	0	0	900	900
000054	1600	01	2480	0	0	1700	935
000054	1600	01	26196	0	0	1700	935
000055	Seinö 024-16-1			0	0	0	0
000055	0100	03	0	0	0	900	900
000055	0100	-3	28596	0	0	900	900
000055	1600	01	2480	0	0	1700	935
000055	1600	01	26196	0	0	1700	935
000056	Seinö 024-17-1			0	0	0	0
000056	0100	03	0	0	0	900	900
000056	0100	-3	28596	0	0	900	900
000056	1600	01	2480	0	0	1700	935
000056	1600	01	26196	0	0	1700	935
000057	Seinö 024-18-1			0	0	0	0
000057	0100	03	0	0	0	900	900
000057	0100	-3	28596	0	0	900	900
000057	1600	01	2480	0	0	1700	935
000057	1600	01	26196	0	0	1700	935

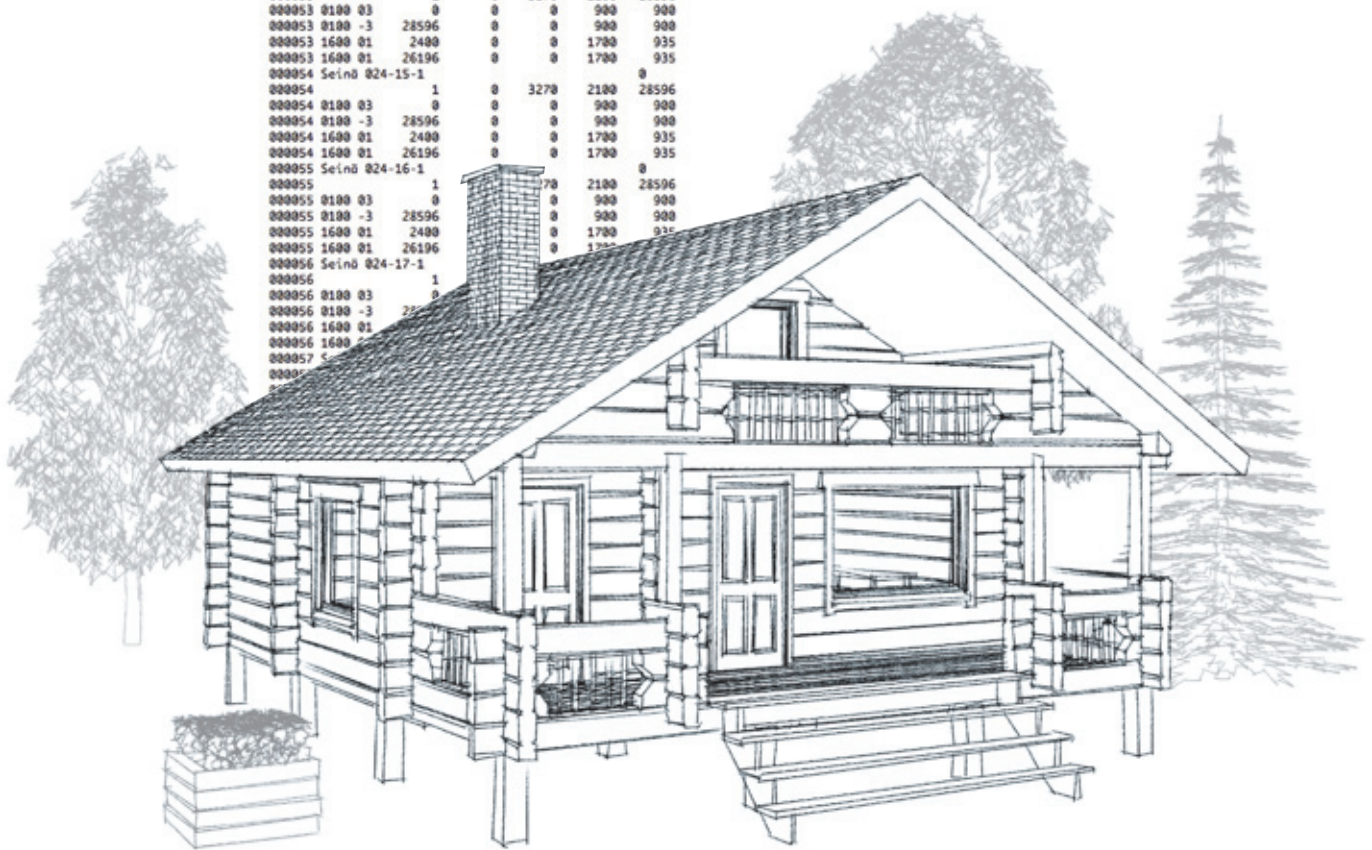

Automatically updated documents

ArchiLogs combines the benefits of an application suite with the smooth workflow of an integrated solution. ArchiLogs works seamlessly with ArchiCAD to extract all project documents from a single database for each project. All changes made in one view are automatically updated in all others. This significantly reduces the time used to produce documentation and ensures all documents are based on the same model.

This also means there is no need to copy information between different software, which reduces the risk of mistakes and speeds up the process. Maintenance and training concentrate on one software program, which makes ArchiLogs cost effective and easy to update. However, if you ever need to exchange data between applications, ArchiLogs can import and export, for example, DWG, DXF, IFC and SketchUp files.

Log wall elevations

Log wall elevations are produced directly from the 3D model produced by ArchiLogs. Customizable toolsets let you quickly and accurately carry out specific machining like drilling or grooving directly on the walls. The wall projections allow you to collect all the information needed in manufacturing, as well as for assembly on site, in a set of easily readable documents. So companies without CNC machinery also benefit from using ArchiLogs.

ArchiLogs

- Enables building information modeling
- Produces all necessary drawings and plans
- Generates files for any CNC machine
- Works together with all ArchiCAD add-ons
- Speeds up the project workflow

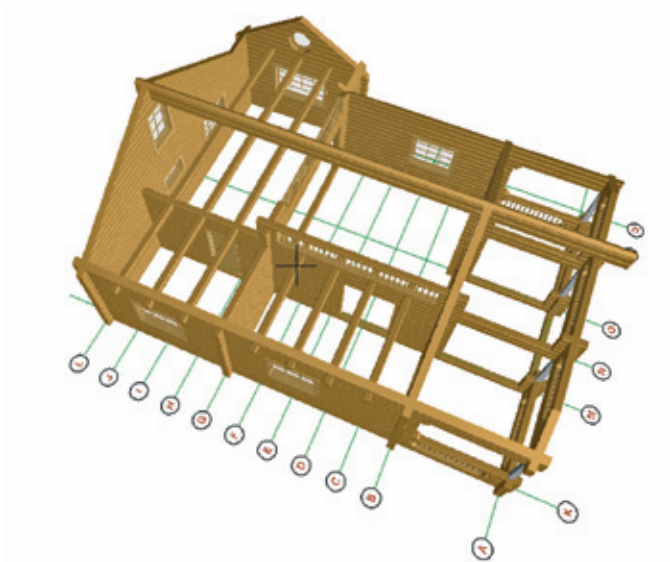
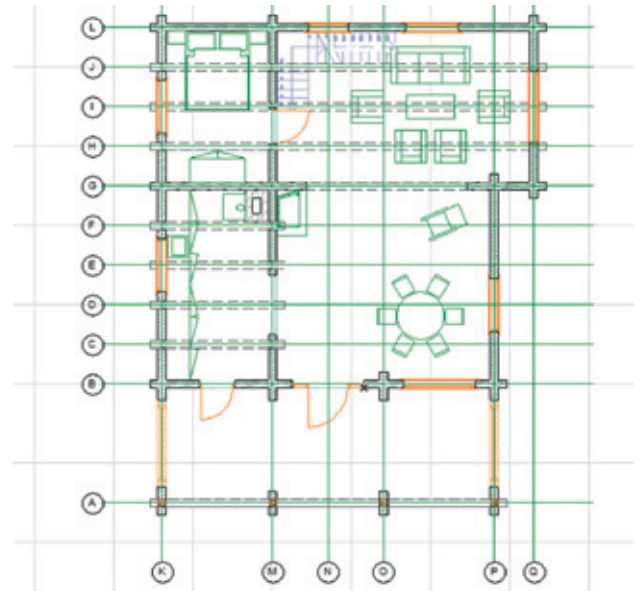
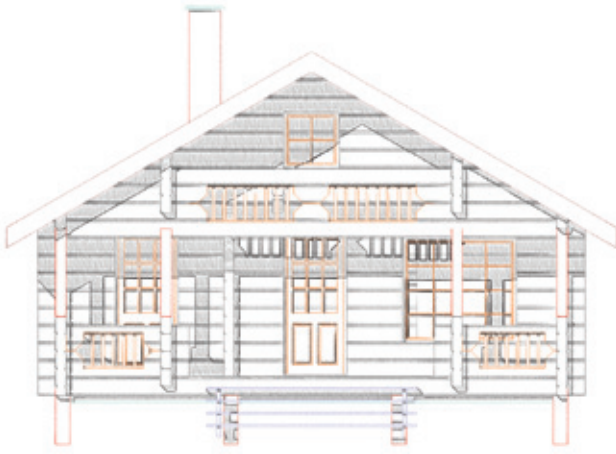

Vivid, real-time design visualization

ArchiCAD already has a built-in Log Details option, but it lacks many specific log construction tools and objects provided by ArchiLogs. Anyone can use ArchiCAD to sketch and draw the plans of a log home, but when it comes to more detailed drawings, ArchiLogs is the perfect solution. All desired details are easy to incorporate into the model with the special ArchiLogs Library, which is part of the add-on. Naturally, the library can be expanded to include your own details and ArchiCAD objects.

Different types of drawings can be created and their appearance adjusted according to your established practice. The model can be viewed and examined three dimensionally at any given moment in the design process. This real-time feedback makes the evaluation of design alternatives quick and uncomplicated, reducing the risk of errors and surprises on site.

Impressive marketing tools

Visual sales materials can be produced directly from the ArchiCAD model. The images can be made from the same views used in the design process. Object libraries offer many usable components to enrich and enliven your perspective images or to reproduce the site of the house in a realistic way.

During sales meetings, the project can be presented in three-dimensional views to the customers to give them a realistic, real-life impression of their house. Modifications can be

made directly in the model, and the effect is visible on screen at once. The result is uncomplicated and real-time communication with your customers.













For more advanced presentations and professional marketing material, ArchiLogs uses ArchiCAD's built-in rendering and animation properties. Animated fly-throughs and tracking shots both through and around the building are an excellent way to communicate your design ideas!

Graphisoft Finland

- Graphisoft Finland's main product is ArchiCAD by Graphisoft. ArchiCAD's market share among architects and log manufacturers in Finland is over 70%.
- Graphisoft Finland also provides consulting and training and develops its own ArchiCAD add-ons.
- Graphisoft Finland, a.k.a. Micro Aided Design Oy, was founded in 1988.

System requirements

- Same as ArchiCAD's

	ArchiCAD	ArchiLogs Designer	ArchiLogs	Customized features
Drawings and 3D models	●			
Plan drawings and elevations	●			
Visualizations	●			
Log wall elevations				
Tables and bills of materials	●			●
ArchiLogs library				
CNC code				●
Training				●
Customized log profiles				●

Manufacturer-specific customization

All log home manufacturers have their own design solutions and patented details that are not included in the basic installation of the ArchiLogs add-on, but these can be added, and ArchiLogs can also be customized in many other ways.

Custom tools can be added for special machining, and the planning precision as well as the visual appearance of the model can be improved by defining the actual timber profiles and dimensions used in your company. All standard methods of customizing your work environment in ArchiCAD are of course available too.

The ArchiLogs accessory list is a further developed configuration of ArchiCAD's own quantity calculation. Sometimes special features are required in addition to the existing schemes and lists. Everything in your ArchiCAD model can be listed – from the amount of timber needed down to every single bolt. Through further customization, the tables and bills created can

even be directly incorporated into your logistical management.

To enable CNC code printing, the commands used in the CNC machinery should be entered into the program. The type of code varies between machines, and only the codes used are entered.

To speed up the modeling, it may be worth coding some special details such as custom objects and parametric functions. For example, the program includes only basic log profiles, and it might be difficult to modify the window objects in the object library to correspond to the real model. For these kind of needs, specific customization comes in handy.

ArchiLogs works seamlessly with ArchiCAD to form an integrated solution that is intuitive and logical and also easy to learn. The ArchiLogs manual is delivered in English or Finnish with every license. It provides step-by-step instructions on how to create exactly the log home model you want.

Contact us

